

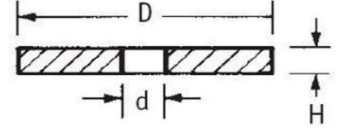

BRT 2063-7

Kilit Pulu

MALZEME : Naylon 6 NATUREL



Ölçü	d	D	H
M2	2.7	5.0	1.5
M3	3.2	7.0	1.4
M3	3.2	5.5	2.2
M3	3.2	9.0	1.5
M3	3.2	15.0	1.5
M4	4.3	9.0	1.4
M4	4.3	7.0	2.3
M4	4.3	12.0	1.4
M4	4.3	18.0	2.0
M5	5.3	11.5	1.4
M5	5.3	8.5	2.8
M5	5.3	15.0	1.5
M6	6.4	12.5	1.6
M6	6.4	10.0	2.8
M6	6.4	18.0	2.0
M8	8.4	13.0	2.8
M8	8.4	40.0	3.0
M8	8.4	15.0	1.5
M10	10.5	21.0	2.5