

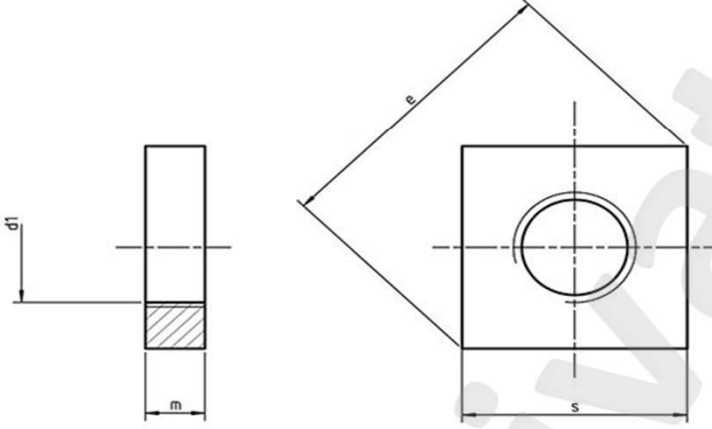

DIN 562 KONTRA KARE SOMUN
Square thin nuts

DIN 562;
PN 82151;
UNI 5596;

* 6K
* A2 304
* A4 316



d	m min.	s
M2	1,20	4,00
M2,5	1,40	5,00
M3	1,60	5,50
M4	1,80	7,00
M5	2,30	8,00
M6	2,72	10,00
M8	3,52	13,00
M10	4,52	17,00